

Karry Ka Wong LAU/PLAND

寄件者: Cyrus Tang <[REDACTED]>
寄件日期: 2026年04月30日星期四 10:51
收件者: tpbpd/PLAND
副本: Karry Ka Wong LAU/PLAND
主旨: S.16 Application No. A/HSK/610 - Replacement Pages (Supersedes the email sent on 29.4.2026 9:56pm)
附件: Form No. S.16-III_Sep 2023 (Replacement Page 3 & 6) (30.4.2026).pdf; Figure 1.pdf; Figure 2.pdf; Figure 3.pdf; Figure 4.pdf; Figure 5.pdf
類別: Internet Email

Dear Sir / Madam,

For the S.16 Application No. A/HSK/610, I hereby submit the replacement pages for the application form and figures in the supplementary planning statement. This email supersedes the one which sent on 29.4.2026 9:56pm. Sorry if it causes any inconvenience.

Regards,

Cyrus TANG

[REDACTED]

(d) Name and number of the related statutory plan(s) 有關法定圖則的名稱及編號	Draft Hung Shui Kiu and Ha Tsuen Outline Zoning Plan No. S/HSK/3 洪水橋及厦村分區計劃大綱草圖編號 S/HSK/3
(e) Land use zone(s) involved 涉及的土地用途地帶	'Village Type Development' ("V") 鄉村式發展
(f) Current use(s) 現時用途	Temporary Public Vehicle Park (Private Car) 臨時公眾停車場(私家車)用途 (If there are any Government, institution or community facilities, please illustrate on plan and specify the use and gross floor area) (如有任何政府、機構或社區設施，請在圖則上顯示，並註明用途及總樓面面積)

4. "Current Land Owner" of Application Site 申請地點的「現行土地擁有人」

The applicant 申請人 –

- is the sole "current land owner"^{#&} (please proceed to Part 6 and attach documentary proof of ownership).
是唯一的「現行土地擁有人」^{#&} (請繼續填寫第 6 部分，並夾附業權證明文件)。
- is one of the "current land owners"^{#&} (please attach documentary proof of ownership).
是其中一名「現行土地擁有人」^{#&} (請夾附業權證明文件)。
- is not a "current land owner"[#].
並不是「現行土地擁有人」[#]。

- The application site is entirely on Government land (please proceed to Part 6).
申請地點完全位於政府土地上 (請繼續填寫第 6 部分)。

5. Statement on Owner's Consent/Notification

就土地擁有人的同意/通知土地擁有人的陳述

- (a) According to the record(s) of the Land Registry as at (DD/MM/YYYY), this application involves a total of "current land owner(s)"[#].
根據土地註冊處截至 年 月 日的記錄，這宗申請共牽涉 名「現行土地擁有人」[#]。

(b) The applicant 申請人 –

- has obtained consent(s) of "current land owner(s)"[#].
已取得 名「現行土地擁有人」[#]的同意。

Details of consent of "current land owner(s)" [#] obtained 取得「現行土地擁有人」 [#] 同意的詳情		
No. of 'Current Land Owner(s)' 「現行土地擁有人」數目	Lot number/address of premises as shown in the record of the Land Registry where consent(s) has/have been obtained 根據土地註冊處記錄已獲得同意的地段號碼/處所地址	Date of consent obtained (DD/MM/YYYY) 取得同意的日期 (日/月/年)
Not Applicable 不適用		

(Please use separate sheets if the space of any box above is insufficient. 如上列任何方格的空間不足，請另頁說明)

Proposed operating hours 擬議營運時間		
(d) Any vehicular access to the site/subject building? 是否有車路通往地盤/ 有關建築物?	Yes 是	<input checked="" type="checkbox"/> There is an existing access. (please indicate the street name, where appropriate) 有一條現有車路。(請註明車路名稱(如適用))	Kwu Tung Road		
	No 否	<input type="checkbox"/> There is a proposed access. (please illustrate on plan and specify the width) 有一條擬議車路。(請在圖則顯示，並註明車路的闊度)	<input type="checkbox"/>		
(e) Impacts of Development Proposal 擬議發展計劃的影響 (If necessary, please use separate sheets to indicate the proposed measures to minimise possible adverse impacts or give justifications/reasons for not providing such measures. 如需要的話，請另頁註明可盡量減少可能出現不良影響的措施，否則請提供理據/理由。)					
(i) Does the development proposal involve alteration of existing building? 擬議發展計劃是否包括現有建築物的改動?	Yes 是	<input type="checkbox"/> Please provide details 請提供詳情		
	No 否	<input type="checkbox"/>			
(ii) Does the development proposal involve the operation on the right? 擬議發展是否涉及右列的工程?	Yes 是	<input type="checkbox"/> (Please indicate on site plan the boundary of concerned land/pond(s), and particulars of stream diversion, the extent of filling of land/pond(s) and/or excavation of land) (請用地盤平面圖顯示有關土地/池塘界線，以及河道改道、填塘、填土及/或挖土的細節及/或範圍)			
		<input type="checkbox"/> Diversion of stream 河道改道			
		<input type="checkbox"/> Filling of pond 填塘 Area of filling 填塘面積 sq.m 平方米 <input type="checkbox"/> About 約 Depth of filling 填塘深度 m 米 <input type="checkbox"/> About 約			
		<input type="checkbox"/> Filling of land 填土 Area of filling 填土面積 sq.m 平方米 <input type="checkbox"/> About 約 Depth of filling 填土厚度 m 米 <input type="checkbox"/> About 約			
		<input type="checkbox"/> Excavation of land 挖土 Area of excavation 挖土面積 sq.m 平方米 <input type="checkbox"/> About 約 Depth of excavation 挖土深度 m 米 <input type="checkbox"/> About 約			
	No 否	<input type="checkbox"/>			
(iii) Would the development proposal cause any adverse impacts? 擬議發展計劃會否造成不良影響?	On environment 對環境	Yes 會 <input type="checkbox"/>	No 不會 <input type="checkbox"/>		
	On traffic 對交通	Yes 會 <input type="checkbox"/>	No 不會 <input type="checkbox"/>		
	On water supply 對供水	Yes 會 <input type="checkbox"/>	No 不會 <input type="checkbox"/>		
	On drainage 對排水	Yes 會 <input type="checkbox"/>	No 不會 <input type="checkbox"/>		
	On slopes 對斜坡	Yes 會 <input type="checkbox"/>	No 不會 <input type="checkbox"/>		
	Affected by slopes 受斜坡影響	Yes 會 <input type="checkbox"/>	No 不會 <input type="checkbox"/>		
	Landscape Impact 構成景觀影響	Yes 會 <input type="checkbox"/>	No 不會 <input type="checkbox"/>		
	Tree Felling 砍伐樹木	Yes 會 <input type="checkbox"/>	No 不會 <input type="checkbox"/>		
	Visual Impact 構成視覺影響	Yes 會 <input type="checkbox"/>	No 不會 <input type="checkbox"/>		
	Others (Please Specify) 其他 (請列明)	Yes 會 <input type="checkbox"/>	No 不會 <input type="checkbox"/>		

**Figure 1:
Site Plan**

Scale:
1:1000

Proposed Development:
**Renewal of Planning
Approval for
Temporary Public
Vehicle Park (Private
Car) for a Period of 3
Years at Lot 1159 RP
(Part) in D.D. 125, Ha
Tsuen, Yuen Long, N.T.**

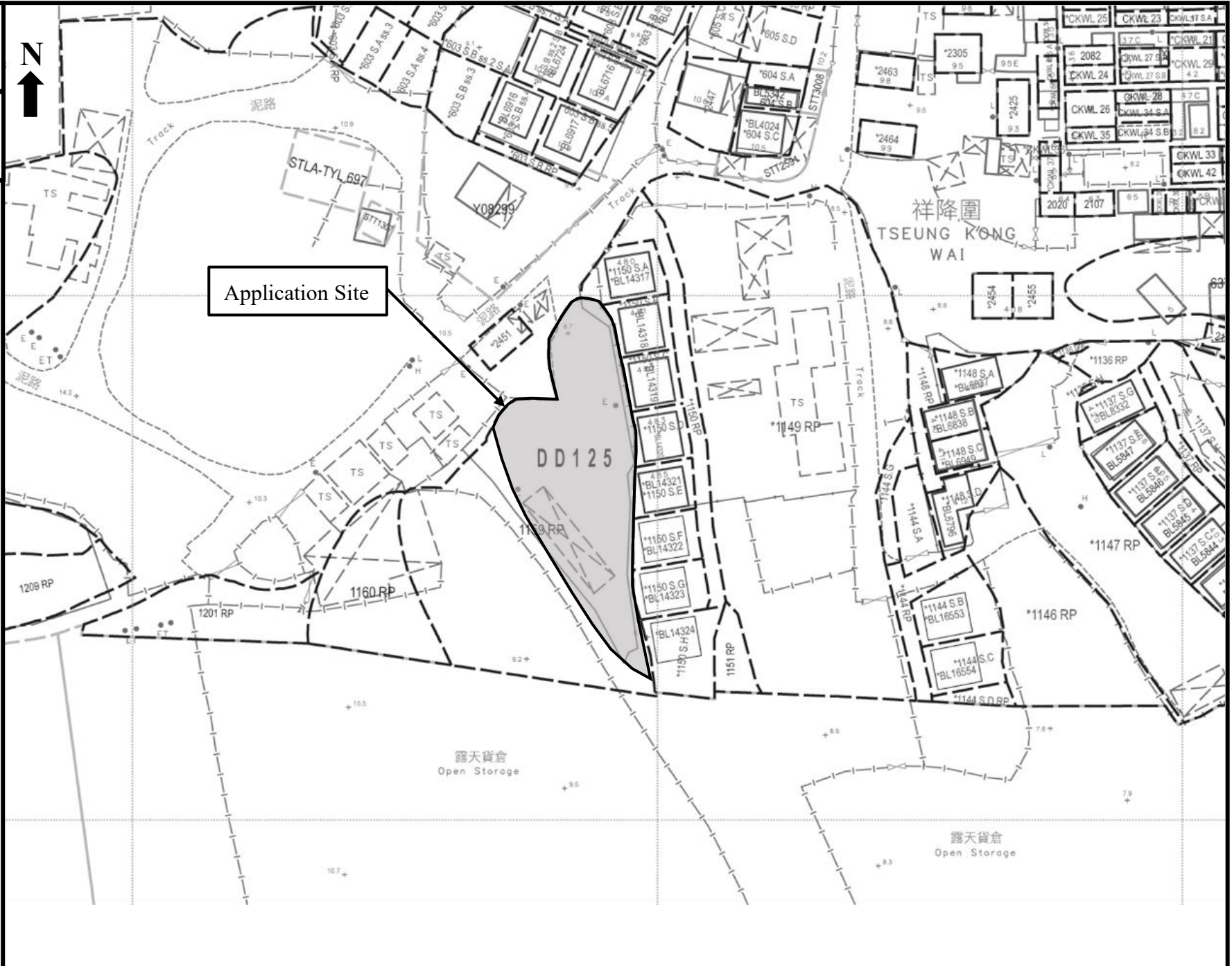

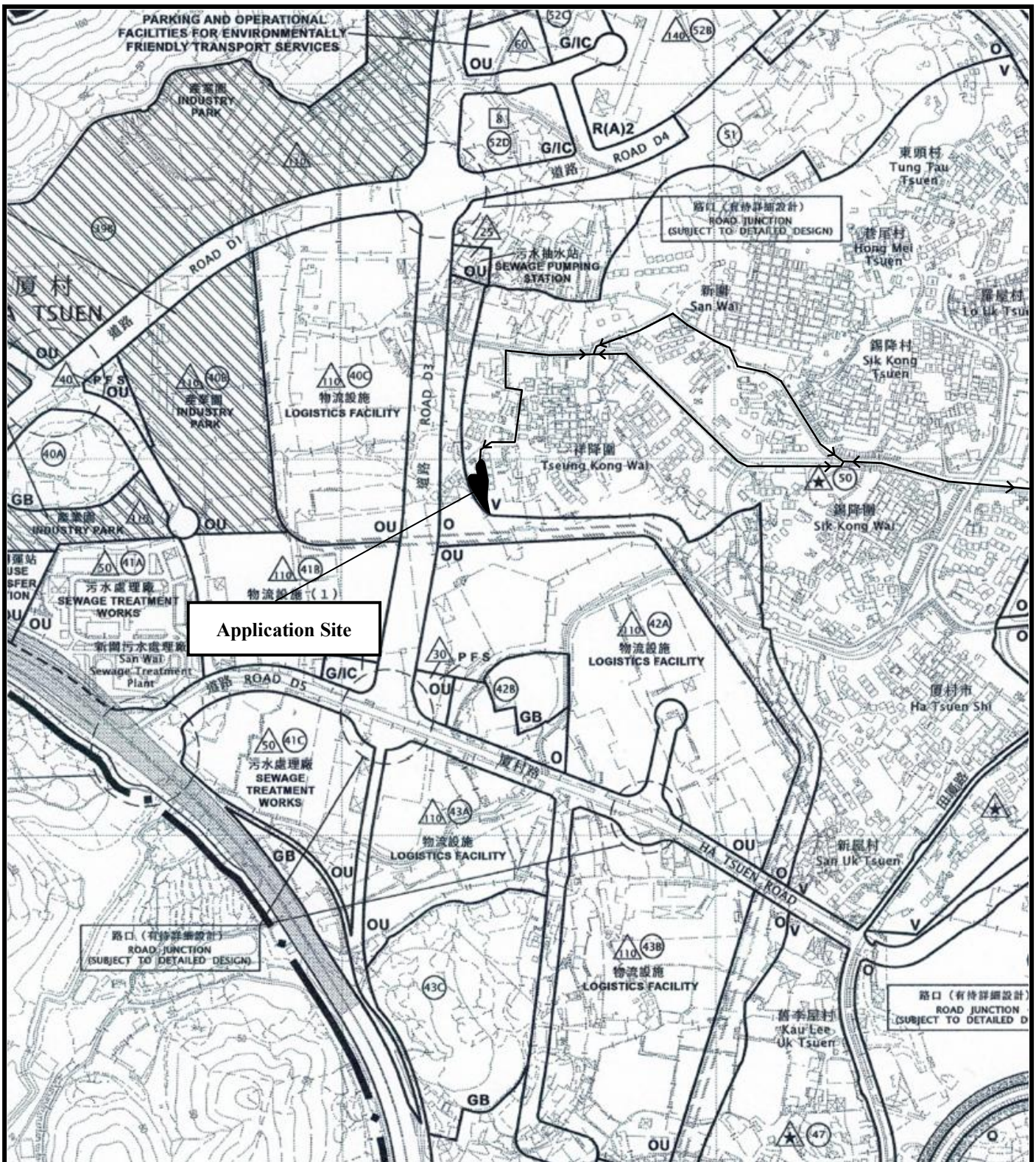
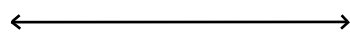

Figure 2:
Extract from OZP No. S/HSK/3

Scale:
1:7500

Proposed Development:
Renewal of Planning Approval for Temporary Public Vehicle Park (Private Car) for a Period of 3 Years at Lot 1159 RP (Part) in D.D. 125, Ha Tsuen, Yuen Long, N.T.

Remarks:



Vehicular Access Leading from San Sik Road

**Figure 3:
Layout Plan**

Scale:
1:1000

Proposed Development:
**Renewal of Planning
Approval for
Temporary Public
Vehicle Park (Private
Car) for a Period of 3
Years at Lot 1159 RP
(Part) in D.D. 125, Ha
Tsuen, Yuen Long, N.T.**

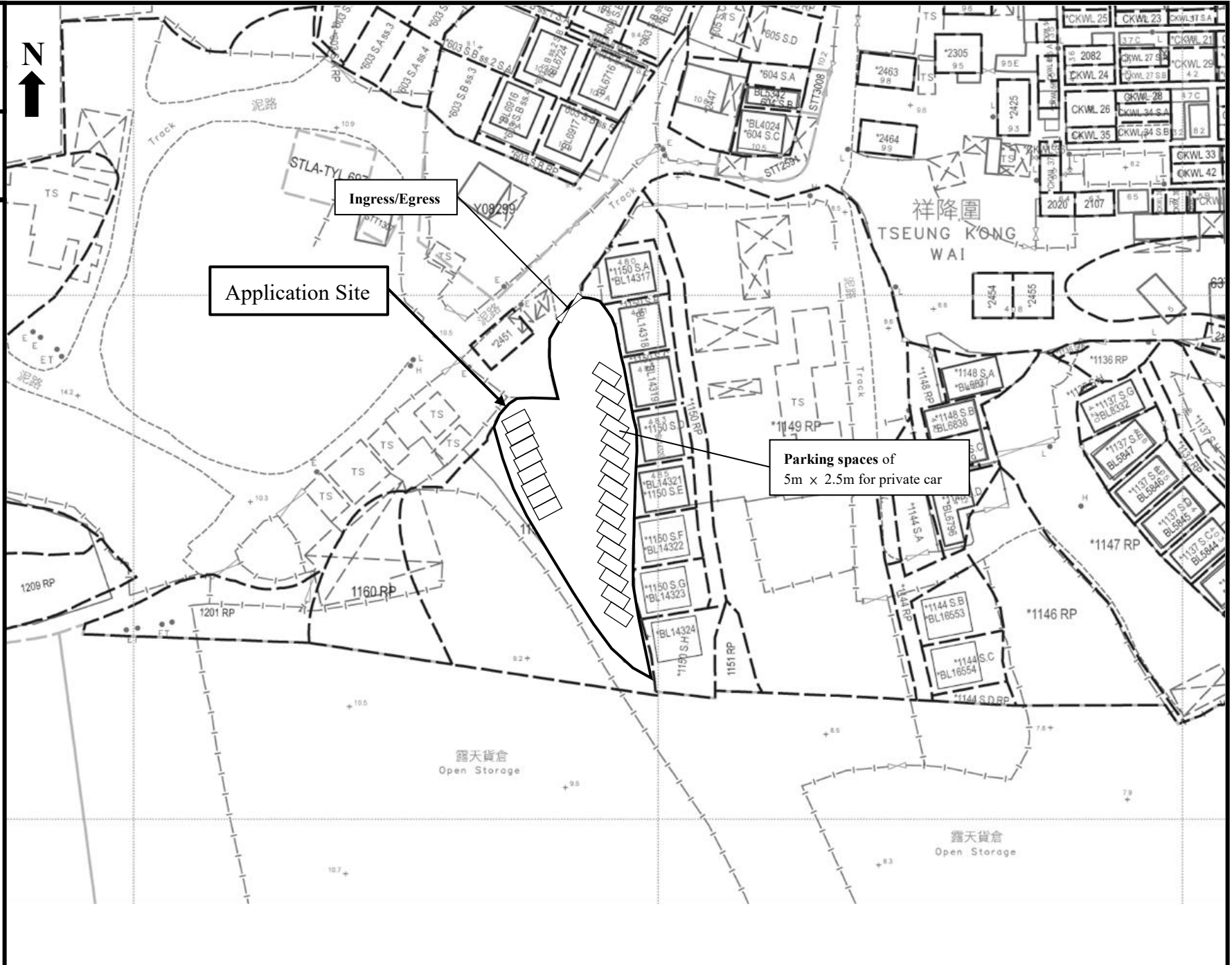

Figure 4:
As-built Drainage Plan
 (Approved under
 previous planning
 permission No.
 A/HSK/449)

Scale:
1:1000

Proposed Development:
**Renewal of Planning
 Approval for
 Temporary Public
 Vehicle Park (Private
 Car) for a Period of 3
 Years at Lot 1159 RP
 (Part) in D.D. 125, Ha
 Tsuen, Yuen Long, N.T.**

Remarks:
 +_{8.7} Spot Level (mPD)
 ← Flow of surface
 runoff
 □ Catchpit with sand
 traps

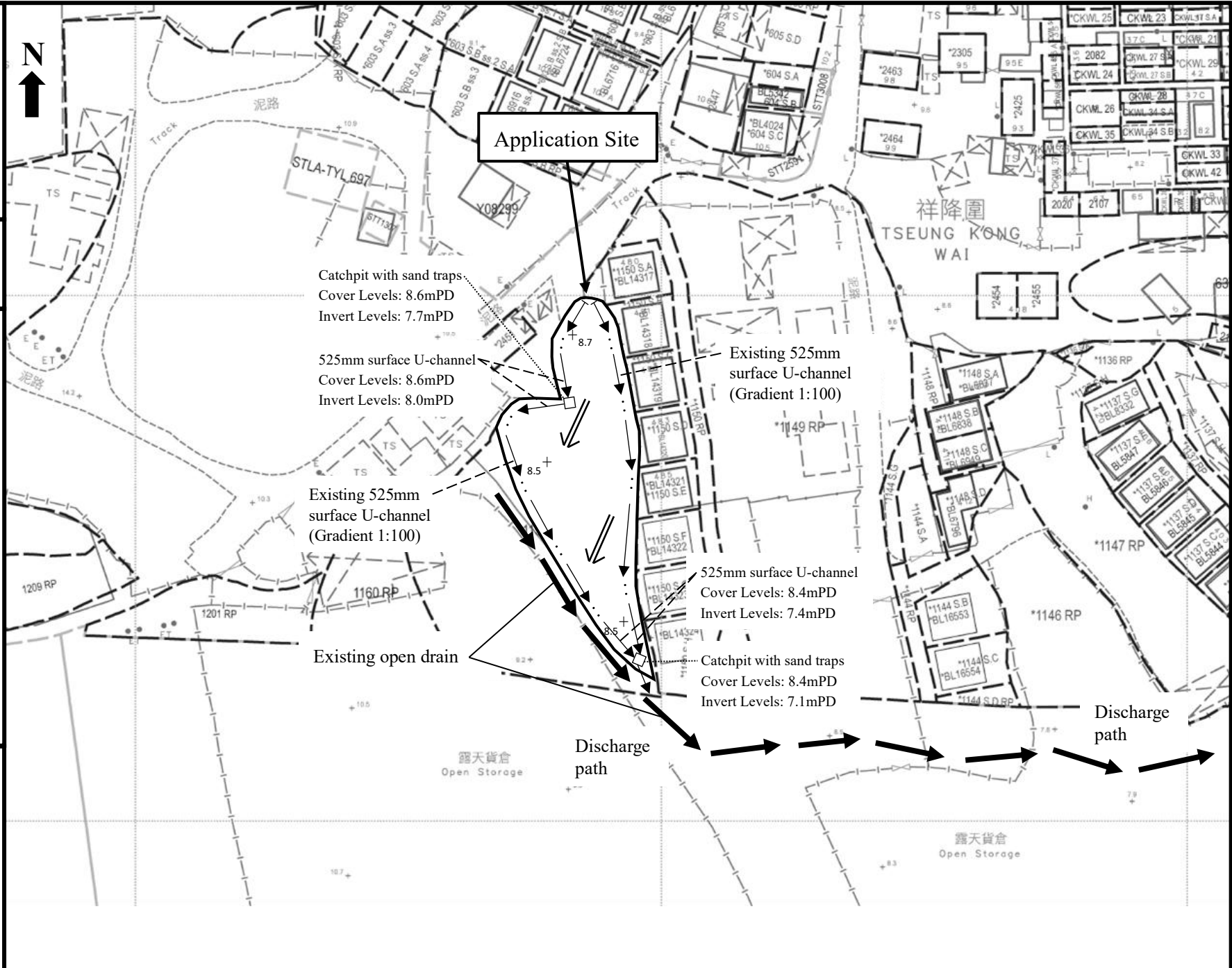

Figure 5:
Existing Fire Service
Installations Plan
 (Approved under
 previous planning
 permission No.
 A/HSK/449)

Scale:
1:1000

Proposed Development:
Renewal of Planning
Approval for
Temporary Public
Vehicle Park (Private
Car) for a Period of 3
Years at Lot 1159 RP
(Part) in D.D. 125, Ha
Tsuen, Yuen Long, N.T.

Remarks:
F.E. **4kg dry powder**
fire extinguisher

